

Dimensional drawing

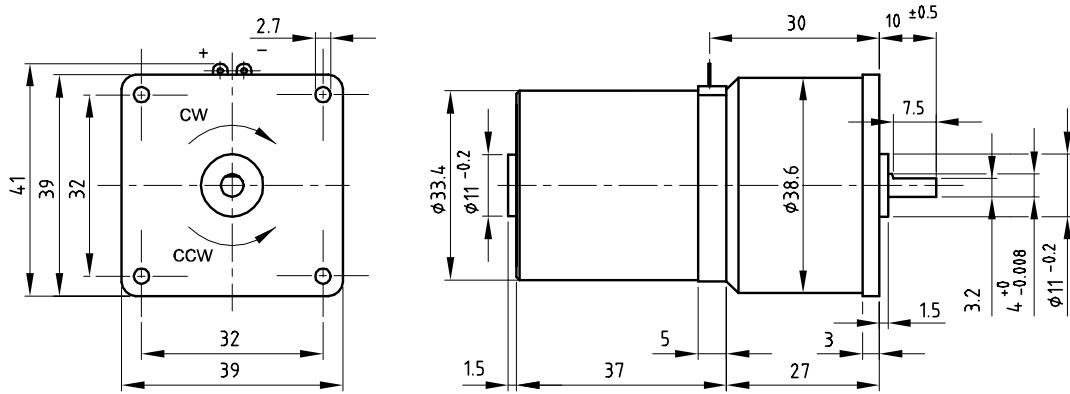

Gear Motor data

Gear motor Order number	Gear ratio	Direction of rotation	Nominal voltage [V]	Maximal voltage [V]	Maximum torque continuous [Nm] (nominal load)	Maximum torque intermittent [Nm]	Speed at no load [rpm]	Speed at nominal load [rpm]	Current at no load [mA]	Current at nominal load [mA]	Maximal radial force [N]	Maximal axial force [N]
			6	7.2								
9904 120 53 +	81:1	CW	406	7.2	0.24	0.48	47.3	32.9	103	460	6	6
			606	14.4								
			706	28.8								
407	150.4:1	CCW	607	7.2	0.45	0.8	25.5	16.8	103	502	8	8
			607	14.4								
			707	28.8								
408	243:1	CCW	608	7.2	0.6	0.8	15.8	11.3	103	434	8	8
			608	14.4								
			708	28.8								
409	451.25:1	CW	609	7.2	0.6	0.8	8.5	7.1	103	300	10	10
			609	14.4								
			709	28.8								
411	729:1	CW	611	7.2	0.6	0.8	5.3	4.7	103	225	10	10
			611	14.4								
			711	28.8								

Motor data

	Nominal Voltage [V]	Rotor resist. [Ohm]	Speed at no load [rpm]	Stall torque [mNm]	Torque const. [mNm/A]
9904 120 534..	6	3.6	3800	23	14
9904 120 536..	12	15	3550	23	30
9904 120 537..	24	58	3550	23	61

General data

*	Type of bearings	sleeve	
*	Commutation system	graphite / copper	
*	Gear material	plastic / metal	
*	Axial play	0.5	mm
*	Ambient temp. range operating	-20/+60	°C
*	Ambient temp. range storage	-40/+70	°C
*	Thermal resistance winding-ambient	30	K/W
*	Mass of gear motor	125	g

Options

- * Special shafts
- * Other supply voltage