

### 34MSM - NEMA 34 stepper motor, higher torque, 2 phase, 1.8°

- Holding torque, up to 13 Nm
- Standard models available from stock
- Cost optimised OEM range
- Mechanical or electrical customisation is available upon request
- Part of wide range in NEMA sizes 08, 11, 14, 17, 23 and 34



### 34MSM - Specification

Mclennan Part Number	Motor Length mm	Shaft Diameter mm	Rated Current Amps	Holding Torque Nm Typ	Resistance $\Omega$ $\pm 10\% @ 20^\circ\text{C}$	Inductance mH	Detent Torque mNm	Rotor Inertia g cm <sup>2</sup>	Motor Weight kg
34MSM067035-S	66.5	12.7	3.5	3.8	0.95	9.5	90	915	1.6
34MSM067035-D	66.5	12.7	3.5	3.8	0.90	9.0	90	915	1.6
34MSM067050-S	66.5	12.7	5.0	3.8	0.48	4.5	90	915	1.6
34MSM067050-D	66.5	12.7	5.0	3.8	0.48	4.4	90	915	1.6
34MSM067100-S	66.5	12.7	10.0	3.8	0.14	1.13	90	915	1.6
34MSM067100-D	66.5	12.7	10.0	3.8	0.14	1.0	90	915	1.6
34MSM096070-S	96.0	12.7	7.0	7.2	0.36	4.0	150	1480	2.7
34MSM096070-D	96.0	12.7	7.0	7.2	0.36	4.0	150	1480	2.7
34MSM157100-S	157.0	12.7	10.0	13.0	0.24	2.9	250	3740	4.9
34MSM157100-D	157.0	12.7	10.0	13.0	0.24	2.9	250	3740	4.9

Parameter	Value
Phase	2
Step Angle	1.8°
Shaft	Single or double
Frame Size	NEMA34 (86 mm)

Parameter	Value
Coil Type	Bi-Polar
Terminal Number	4
Connection	Leads
Insulation Class	B (130°C)

Parameter	Value
Certification	RoHS
IP Rating	IP40



## 34MSM - Dimensions (mm)

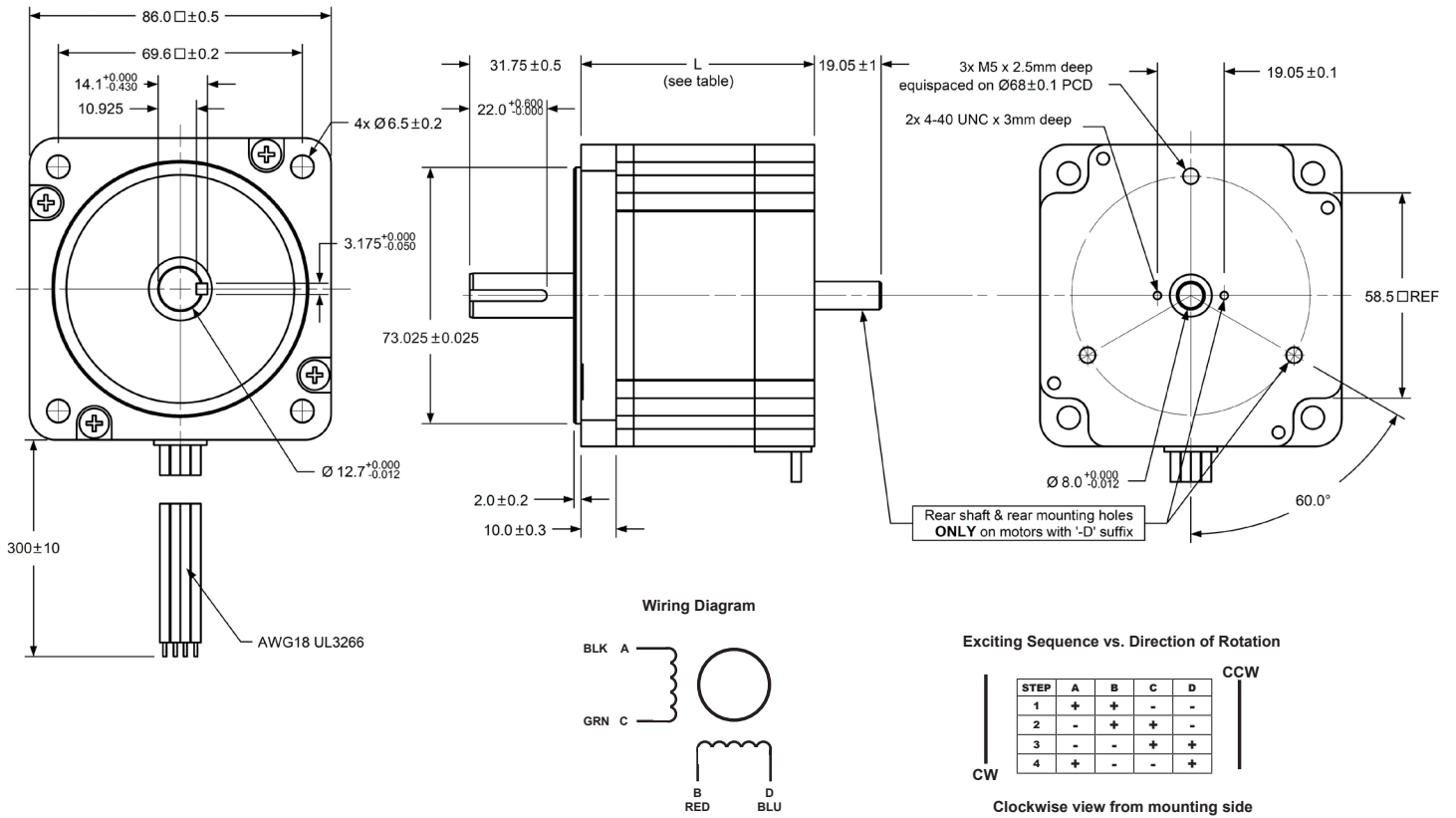

## 34MSM - Torque Curves Typical performance (Pull-Out torque)

### 34MSM067035-S & D

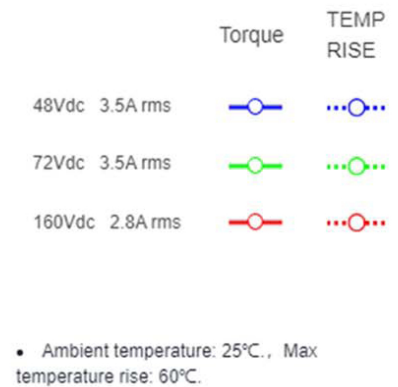
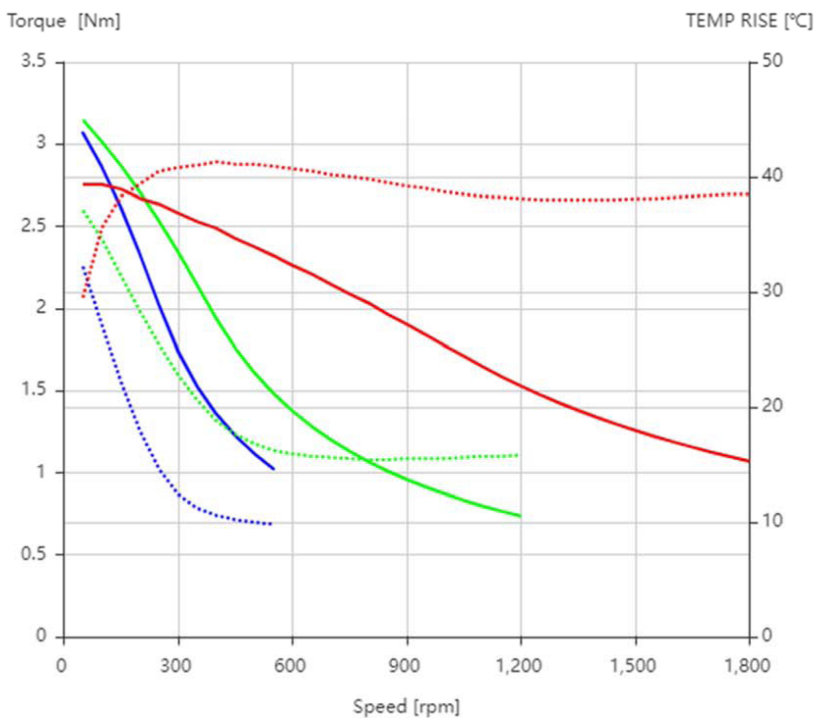



## 34MSM - Torque Curves Typical performance (Pull-Out torque)

### 34MSM067050-S & D

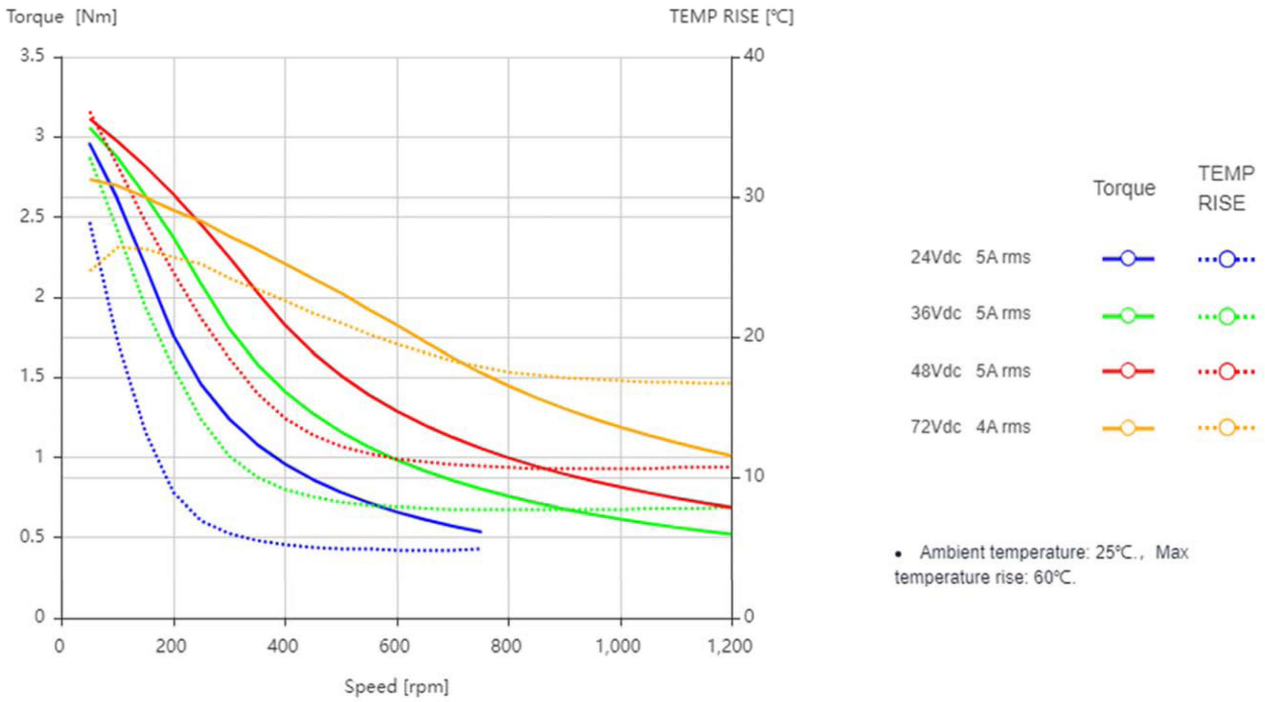

### 34MSM067100-S & D

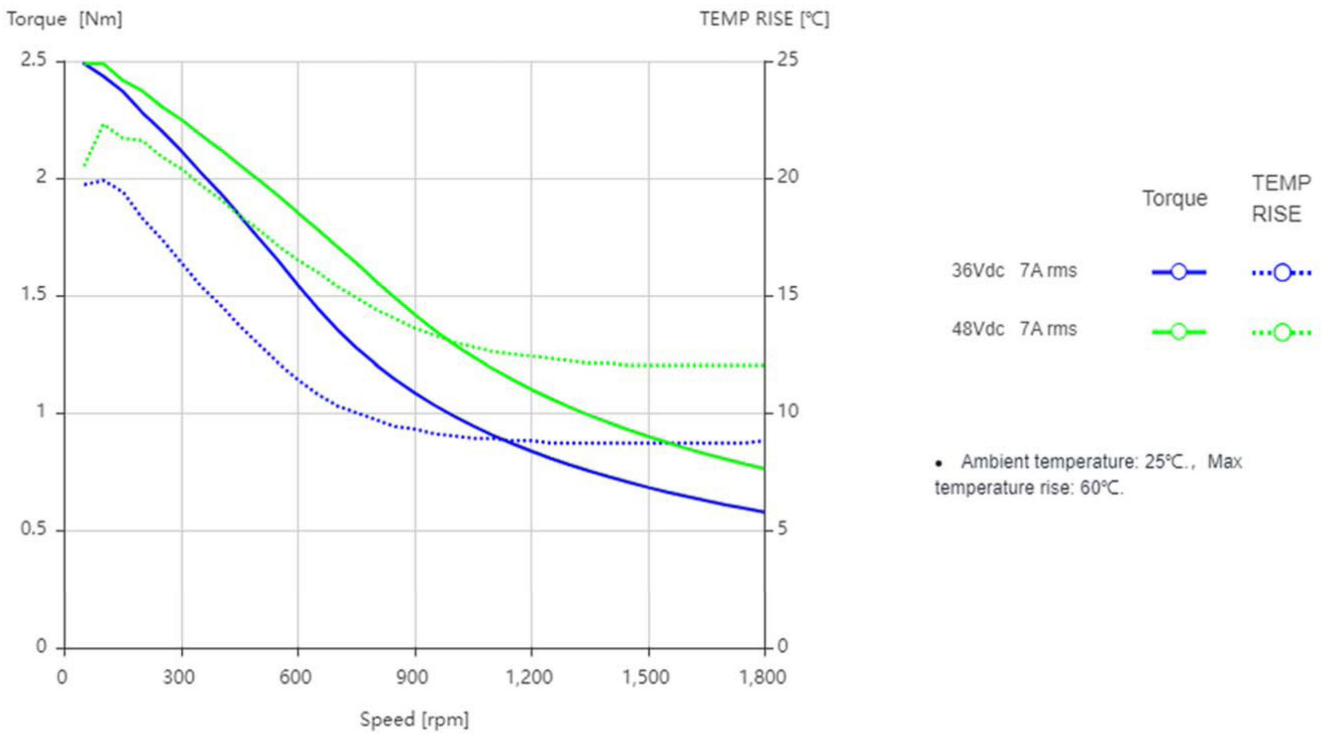



## 34MSM - Torque Curves Typical performance (Pull-Out torque)

34MSM097070-S & D

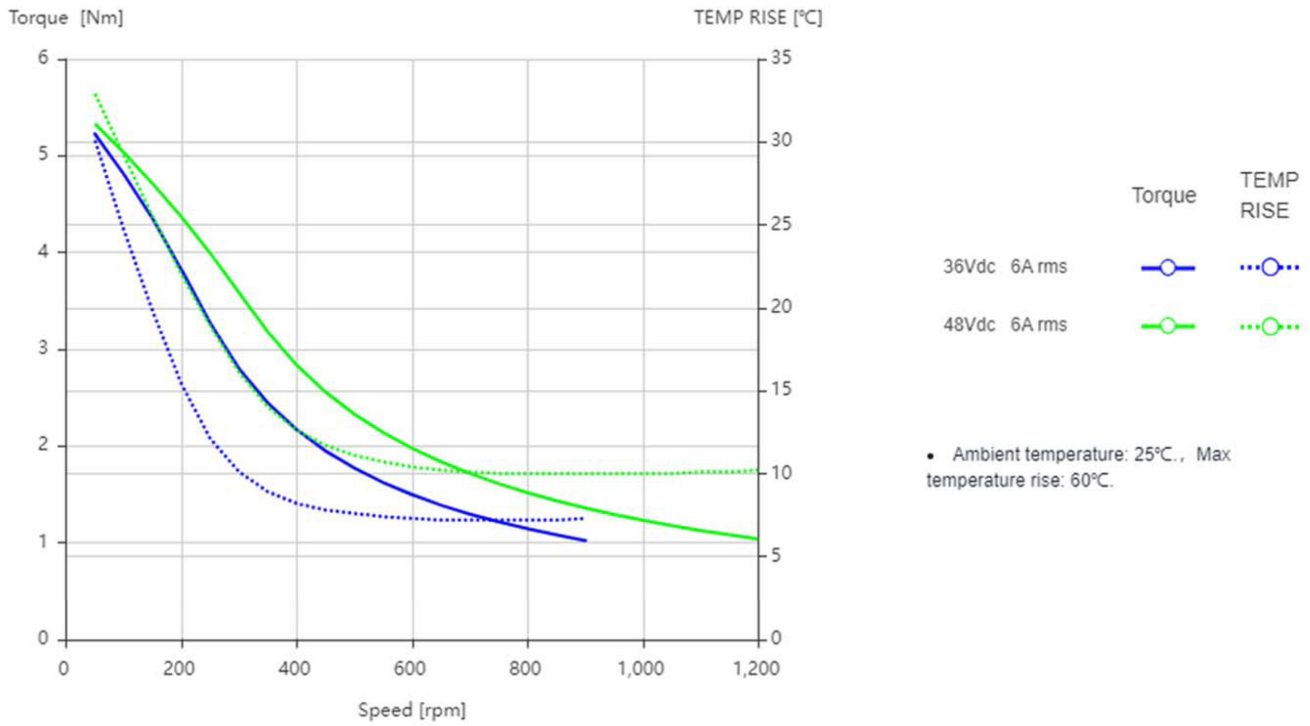

34MSM157100-S & D

